

0.060" CLEAR ANODIZED
ALUM. CENTERING PLATE
CONT. RUBBER INSERT
CONT. ALUM EXPOSED EXTRUSION.
CLEAR ANODIZED FINISH
CLIPS (FIELD INSTALLED)
FASTENERS @ 20" O.C. MAX, BY INSTALLER

CONT. ALUM BASE MEMBER,
MILL FINISH

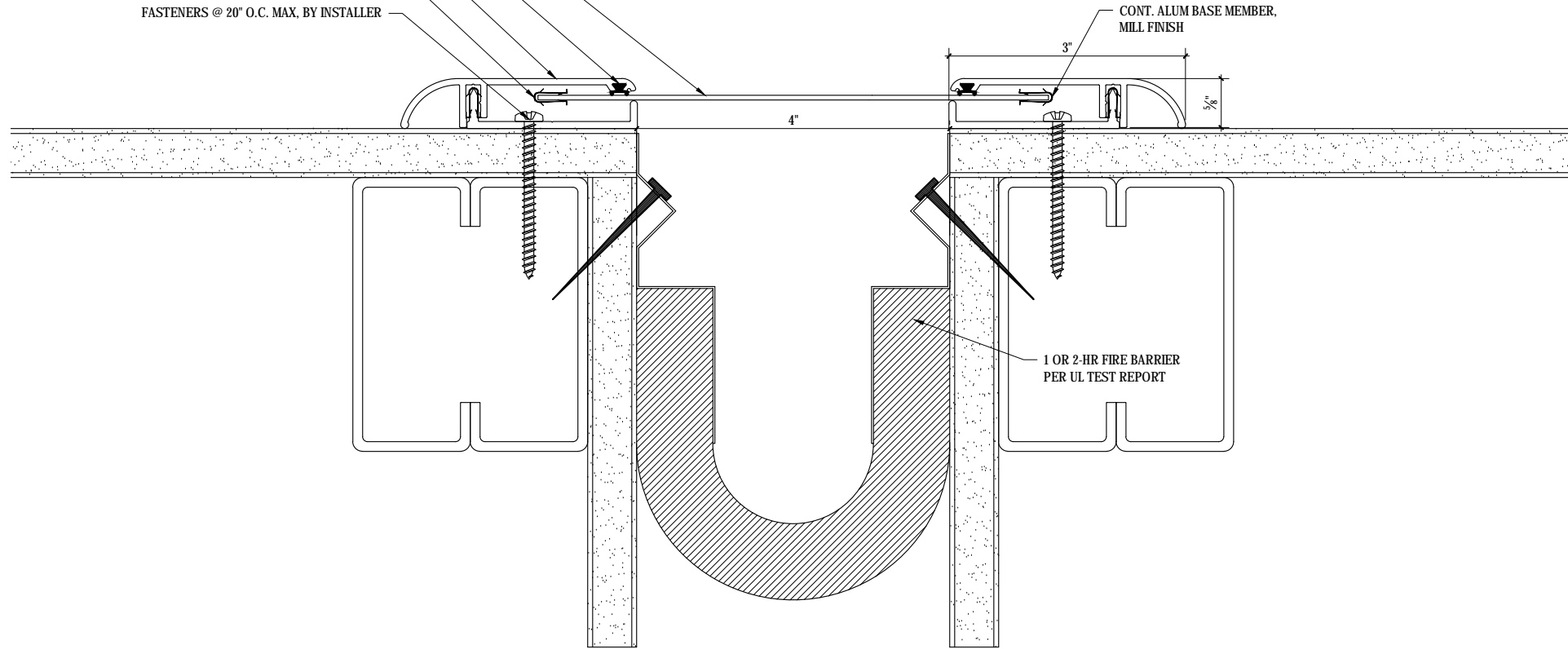

1 OR 2-HR FIRE BARRIER
PER UL TEST REPORT

SCALE: 6"=1'-0"



M.H. POWELL & CO., INC.
ARCHITECTURAL SEISMIC EXPANSION JOINT SYSTEMS

2313 YATES AVENUE | PHONE : (323) 887-0037
COMMERCE, CA 90040 | FAX : (323) 887-0877
WEB : www.mhpowell.net

MODEL
KHR-4-2
INT. WALL/CEILING EJC

PROJECT : _____ PROJECT # : _____
LOCATION : _____ DATE : _____
ARCHITECT : _____
CUSTOMER : _____

PAGE #