

MHP S.S. FASTENERS w/ S.S. BONDED NEOPRENE WASHER
AND S.S. CENTERING BARS @ 20" O.C.

0.090" ALUM. COVER PLATE. MILL FINISH
(5052-H32)

CLOSURE CAP

CONT. ALUM. EXTRUSION

ROOF MEMBRANE

ALUM. BASE FRAME

CANT STRIP BY OTHERS

WEATHER SEAL

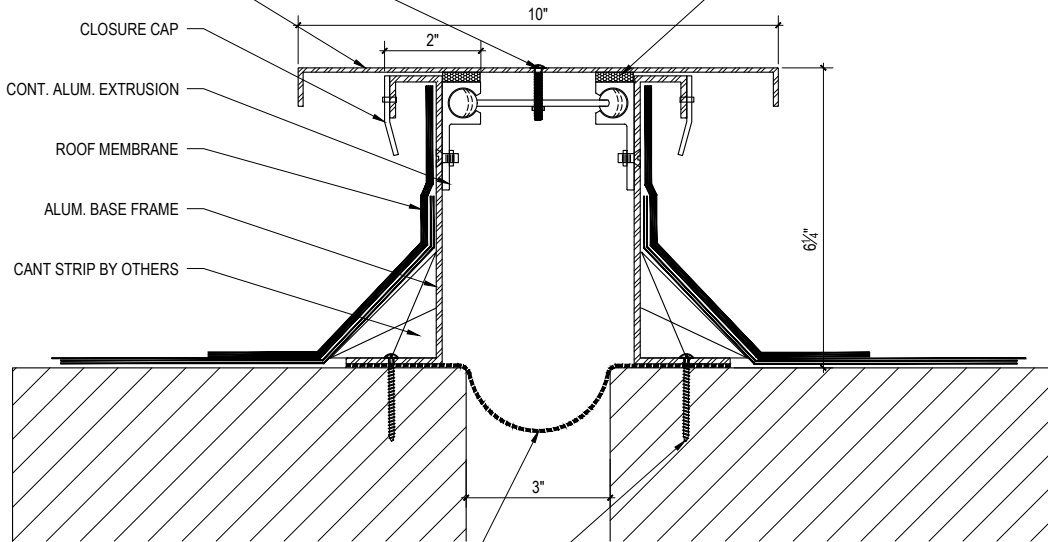

CONT. MHP VAPOR BARRIER

SEALED 1 1/2" FASTENERS @ 20" O.C. MAX
BY INSTALLER



M.H. POWELL & CO., INC.
ARCHITECTURAL SEISMIC EXPANSION JOINT SYSTEMS

2313 YATES AVENUE | PHONE : (323) 887-0037
COMMERCE, CA 90040 | FAX : (323) 887-0877
WEB : www.mhpowell.net

MODEL
CRR-3-3
ROOF TO ROOF

PROJECT : _____ PROJECT # : _____
LOCATION : _____ DATE : _____
ARCHITECT : _____
CUSTOMER : _____

PAGE #